

MicroPlant 3,2 mm

Implantologie/Implantology

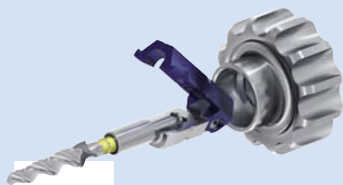

- 1** Abtragen spitzer Grate
*Removal/smoothing
of sharp ridges*
H14 1A



- 2** Vorbohren
Pilot drilling
340L9B/L12B/L15B
⊖_{opt.} 800 - 1000 min⁻¹
max. 30 Ncm

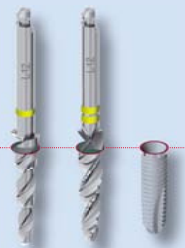
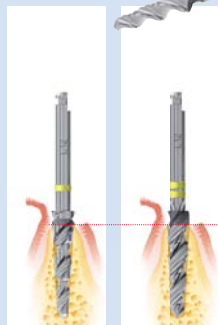

- 3** Implantatbett räumen
Implant site reaming
34 1L9B/L12B/L15B
⊖_{opt.} 30 - 100 min⁻¹

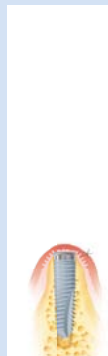

- 4** Insertion/Handschlüssel
Insertion/Hand wrench
295B



MicroPlant 3,2 mm

Prothetik/Prosthetics



5

Freilegen/Hautstanze
Exposure/Tissue punch
222.644.035

Entfernen
der Verschlusschraube
Removal of sealing cap
295B



6

Einschrauben/Primäranker
Screwing in primary anchor

A Druckknopf/Press button
150.296A

B STECO®
Magnet/Magnet
150.465

[max. 13 Ncm]
Nach 10 Tagen:
After 10 days:

[13–16 Ncm]

Ratsche
Ratchet (Torque wrench)
9820A

